

# END FITTINGS

Loops and brackets – Stainless



## 139. Loop M6

AISI 303 (E No. 1.4305)

Cat.no: S1137

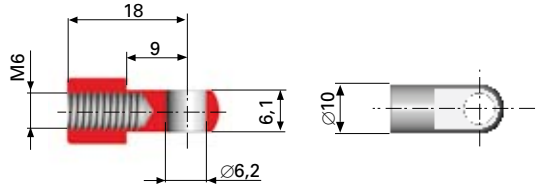

## 125. Loop M6

W 1.4305 (E No. 1.4305)

Cat.no: S1129

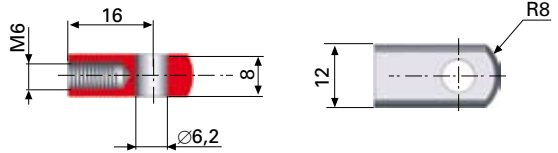

## 129. Loop M8

W 1.4305 (E No. 1.4305)

Cat.no: S1133

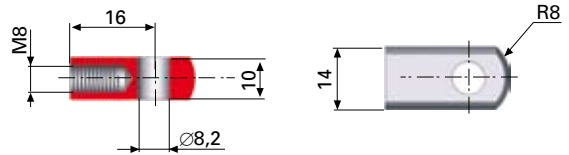

## 140. Loop M8

AISI 303 (E No. 1.4305)

Cat.no: S1138

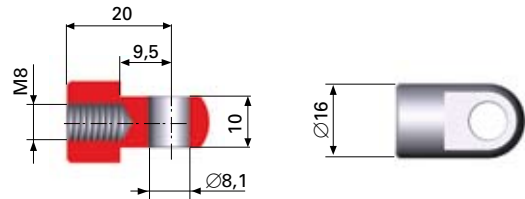

## 128. Bracket

SS2333-02 (E No. 1.4301)

Bolt and locking clip included

Cat.no: S1132

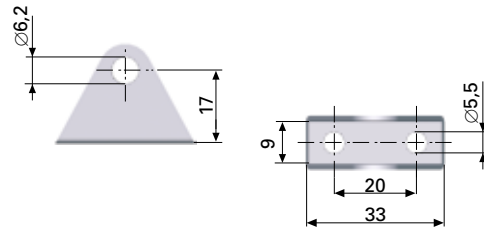

## 132. Bracket

SS2333-02 (E No. 1.4301)

Bolt and locking clip included

Cat.no: S1136

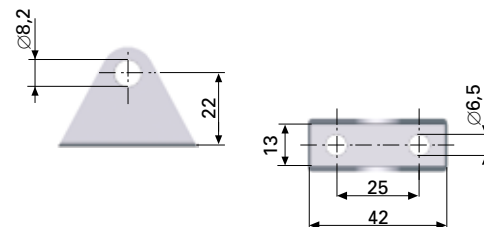

# END FITTINGS

Clevises, ballcups, ball joints and ball studs – Stainless

## 126. Clevis M6

W 1.4305 (E No. 1.4305)

Cat.no: S1130

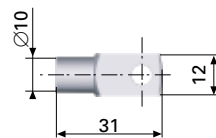
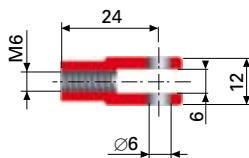

## 130. Clevis M8

W 1.4305 (E No. 1.4305)

Cat.no: S1134

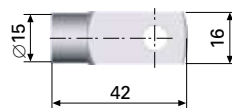
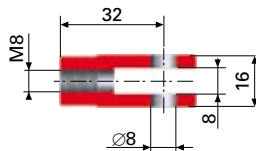

## 138. Ballcup M6, Ø 10

Plastic, black

Locking clip STS301  
(E No. 1.4310)

Cat.no: 4629

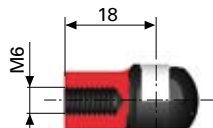

## 127. Ball joint M6

W 1.4305 (E No. 1.4305)

Cat.no: S1131

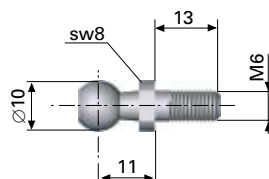
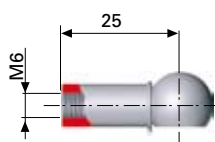

## 131. Ball joint M8

W 1.4305 (E No. 1.4305)

Cat.no: S1135

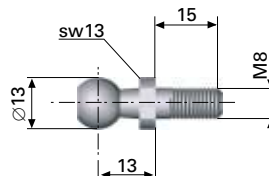
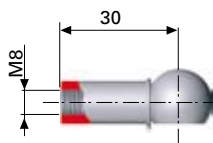

## 145. Ball stud M8, Ø 10

W 1.4305 (E No. 1.4305)

Cat.no: S1139

